

K.C.W.

SURVEYOR'S OFFICE
Hamilton County

Kenton C. Ward, CFM
 Surveyor of Hamilton County
 Phone (317) 776-8495
 Fax (317) 776-9628

Suite 188
 One Hamilton County Square
 Noblesville, Indiana 46060-2230

December 1, 2020

To: Hamilton County Drainage Board

Re: Stony Creek Drainage Area, Weaver & Hooke Arm

At this time a maintenance work order is being sent out for the dredging of a portion of the open ditch section of the Weaver & Hooke Drain. This section begins at Station 12+43.74 (approximately Station 34+72 of the William Weaver Main Drain per the 1906 description) to Station 40+84.33 (approximately Station 29+98 of the William Weaver Arm 1 per the 1906 description) as shown on the attached plan dated August 28, 2020 prepared by the Hamilton County Surveyor's Office.

In order to protect the drain from siltation I recommend that a twenty (20) foot filter strip be installed on both sides of the Weaver & Hooke Open Ditch on the following tracts:

Irving Materials, Inc.	Tract 12-11-02-00-00-002.000
David & Pamela D. Sweitzer	Tract 12-11-02-00-00-003.000
David & Pamela D. Sweitzer	Tract 12-07-35-00-00-015.000
James R. & Delores L. Galloway	Tract 12-07-35-00-00-014.000
James R. & Delores L. Galloway	Tract 12-11-02-00-00-011.000

The filter strips would be 20 feet in width from the top of bank of the open ditch on both sides of the ditch. They would run from approximately 125 feet west of Pennington Road to approximately 394 feet west of Middletown Avenue.

The cost estimate for this project is as follows:

Seeding 2.61 Acres x \$1,200.00/ac \$3,132.00

Upon review of the proposal I do not believe that any damages shall result to the landowners affected by the proposed project. Therefore, damages shall be set at \$0.00.

At this time the maintenance fund has a balance of \$539,737.60. I recommend the Board transfer the cost estimate amount above for this work to a reconstruction fund to cover the cost of the proposed reconstruction as per IC 36-9-27-45.5. Also, due to the low cost the work should be performed by the Board's maintenance contractor which is completing the dredging work.

I recommend the Board set a hearing for this for January 25, 2021.

Sincerely,

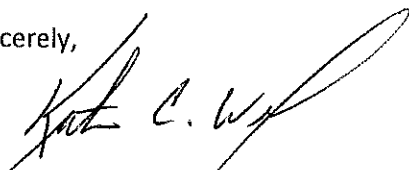

Kenton C. Ward, CFM
Hamilton County Surveyor

KCW/llm

Hamilton County, Indiana

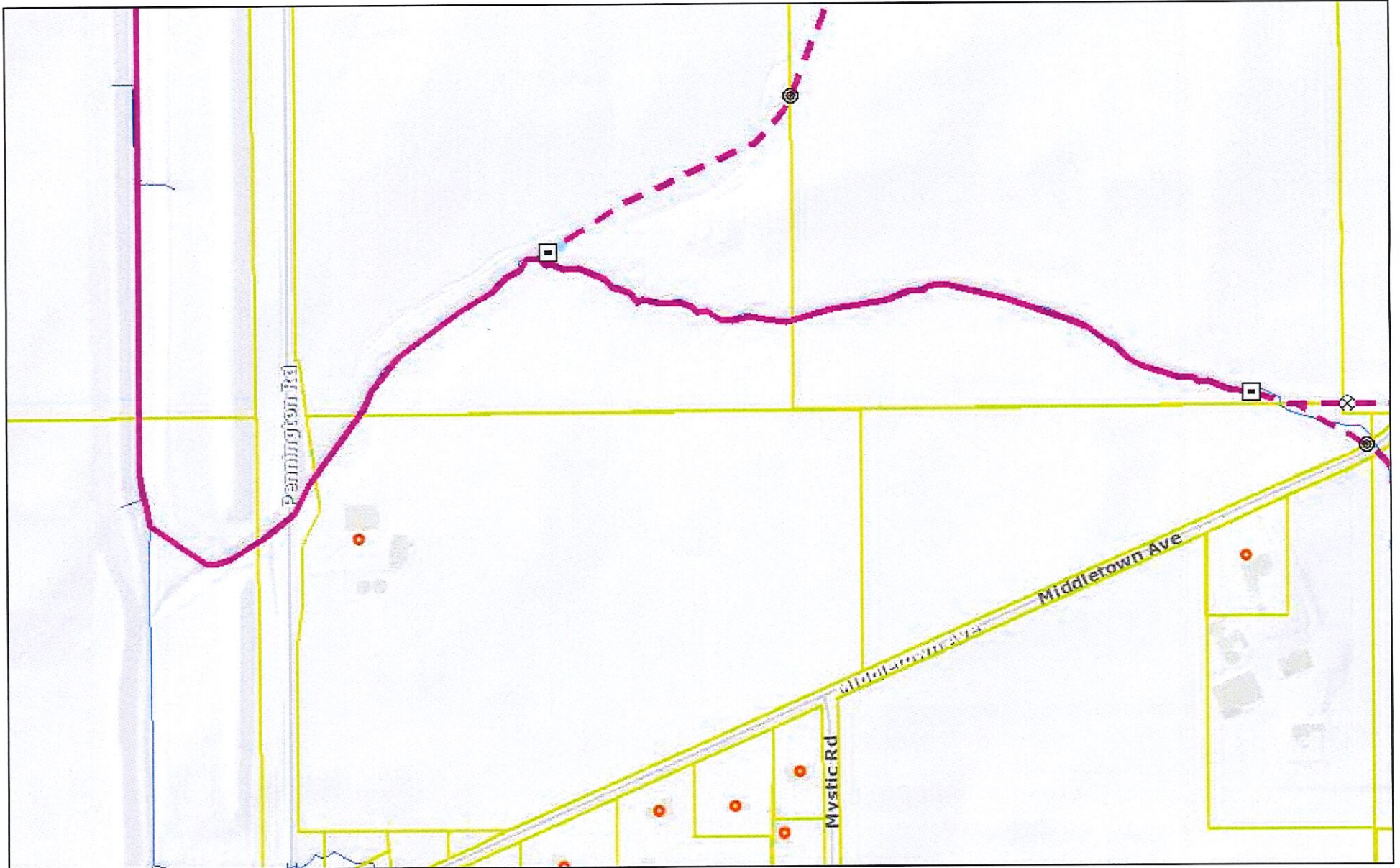

December 1, 2020

Drains - Drainage Structures

- ⊙ BREATHER
- ⊗ CATCH BASIN

▣ HEADWALL - RETAINING WALL

Drains - Regulated Drains

— CLOSED DRAIN

— OPEN DRAIN

Parcels (Internal)

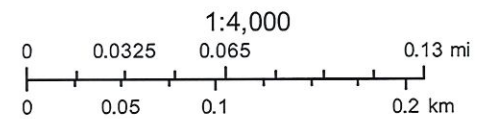

Stony Creek Drainage Area, Weaver & Hooke Arm

A 20' filter strip will be installed on parcels as listed below. Damages are set at \$0.00.

* Reconstruction to be paid from maintenance fund.

**No change in current maintenance assessment rates.

Hearing: 01/25/21

Parcel	Owner	Filter Strips	Description	Benefit	Mnt Asmt	Rec Asmt	Percent of Total
12-11-02-00-00-002.000	Irving Materials Inc.	Filter strips on both sides of ditch	S2 T18 R5 79.58 Ac	*	**	*	20.00%
12-11-02-00-00-003.000	Sweitzer, David & Pamela D.	Filter strips on both sides of ditch	S2 T18 R5 27.38 Ac	*	**	*	20.00%
12-07-35-00-00-015.000	Sweitzer, David & Pamela D.	Filter strips on both sides of ditch	S35 T19 R5 39.19 Ac	*	**	*	20.00%
12-07-35-00-00-014.000	Galloway, James R. & Delores L.	Filter strips on both sides of ditch	S35 T19 R5 70.00 Ac	*	**	*	20.00%
12-11-02-00-00-011.000	Galloway, James R. & Delores L.	Filter strips on both sides of ditch	S2 T18 R5 17.28 Ac	*	**	*	20.00%
Parcels: 5							100.00%