

SURVEYOR'S OFFICE

Hamilton County

Kenton C. Ward, CFM
Surveyor of Hamilton County
 Phone (317) 776-8495
 Fax (317) 776-9628

Suite 188
One Hamilton County Square
Noblesville, Indiana 46060-2230

December 8, 2020

To: Hamilton County Drainage Board

Re: Mud Creek- Sand Creek Drainage Area, Springdale Estates Drain Extension, Partial Vacation - Addendum

Thompson Thrift requests to vacate a portion of the Mud Creek – Sand Creek Drainage Area, Springdale Estates Drain Extension. This proposal is to facilitate a re-development project on parcel 15-15-06-00-13-039.000 (The Stations at Fishers District, Lot 40) owned by 116 Stations Fishers IN LLC (Thompson Thrift, developer). Per letter by Adam Fischer of Thompson Thrift dated December 2, 2020, "Upon inspection by the County Surveyor's Office and construction of the proposed development on the site, it was determined that this short 30-ft segment of pipe was no longer needed." Previously, this pipe received storm water from an open ditch that no longer exists. The upstream drainage now is routed to the regulated drain via storm pipe and underground detention.

Per the request, the vacation, if approved, will affect 30' linear feet of regulated drain between the following inlet/manhole structures:

Springdale Estates Extension (2008)

STRUCTURES	LENGTH	SIZE	TYPE
33 - 31	30'	36"	RCP

This vacation will remove 30' from the Mud Creek – Sand Creek, Springdale Estates Drain Extension (2008). It should be noted that this is a partial vacation of the drain. The remaining portion of the drain installed with the 2008 Springdale Estates Extension will remain as regulated drain. The 2008 extension was installed as part of the Kroger Plaza project and is located between the 116th Street right-of-way and Sand Creek.

Springdale Estates Drain was previously inventoried as two separate drains under Drain #347. They were inventoried as follows:

- Mud Creek – Sand Creek Drainage Area, Springdale Estates Arm.
- Mud Creek – Sand Creek Drainage Area, Springdale Estates Drain Extension.

Regarding the historical timeline of this drain, on April 5, 1982 the Board held a hearing to establish the Springdale Estates Drain, per my report dated February 26, 1982, as recorded in Drainage Board Minutes Book 1, pages 467-468. On April 23, 2007, the Springdale Estates Drain was made an arm to the Mud Creek-Sand Creek Drainage Area at public hearing, as per my letter dated March 19, 2007, as recorded in Minutes book 10, pages 220-222. On July 28, 2008, the Board approved the Mud Creek/Sand Creek Drain, Springdale Estates Drain Extension, per my report dated June 6, 2008, as recorded in Minutes Book 11, pages 238-240. On July 10, 2012, the Springdale Estates Drain Reconstruction (2013) was approved by the Board per my report dated November 7, 2012, as recorded in Minutes Book 14, pages 434-436. As noted above, the Board approved a partial vacation (332' of open drain) at public hearing on August 28, 2017 as per my report dated July 21, 2017, as recorded in Minutes Book 17, pages 461-462.

I recommend the Board set a hearing for January 25, 2021 per IC 36-9-27-37.

Sincerely,

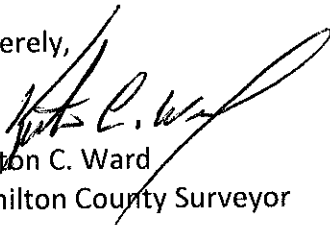

Kenton C. Ward
Hamilton County Surveyor

KCW/stc



Thompson Thrift Development, Inc.
111 Monument Circle, Suite 1500
Indianapolis, IN 46204
TEL 317.848.4755
FAX 317.454.8026

www.thompsonthrift.com

December 2, 2020

Hamilton County Drainage Board
c/o Mr. Kent Ward
County Surveyor
One Hamilton County Square, #188
Noblesville, Indiana 46060

Dear Drainage Board Members,

We respectfully request a portion of the Springdale Estates Extension be vacated as highlighted in the attached exhibit be vacated. Upon inspection by the County Surveyor's Office and construction of the proposed development on the site, it was determined that this short 30-ft segment of pipe was no longer needed. The vacation requested and highlighted in the attached exhibit would remove approximately 30 linear feet of pipe from the legal drain system.

The recent development project improved the drainage on the site and also improved access to the legal drain and the structures by paving areas within the development and by making grade and rim adjustments.

We thank you for your time and please feel free to contact me at (317) 853-5480 if you have any questions.

Respectfully,

A handwritten signature in blue ink that reads 'Adam Fischer'. The signature is fluid and cursive, with a large initial 'A'.

Adam Fischer
Thompson Thrift
For 116th Stations Fishers IN, LLC

Hamilton County, Indiana

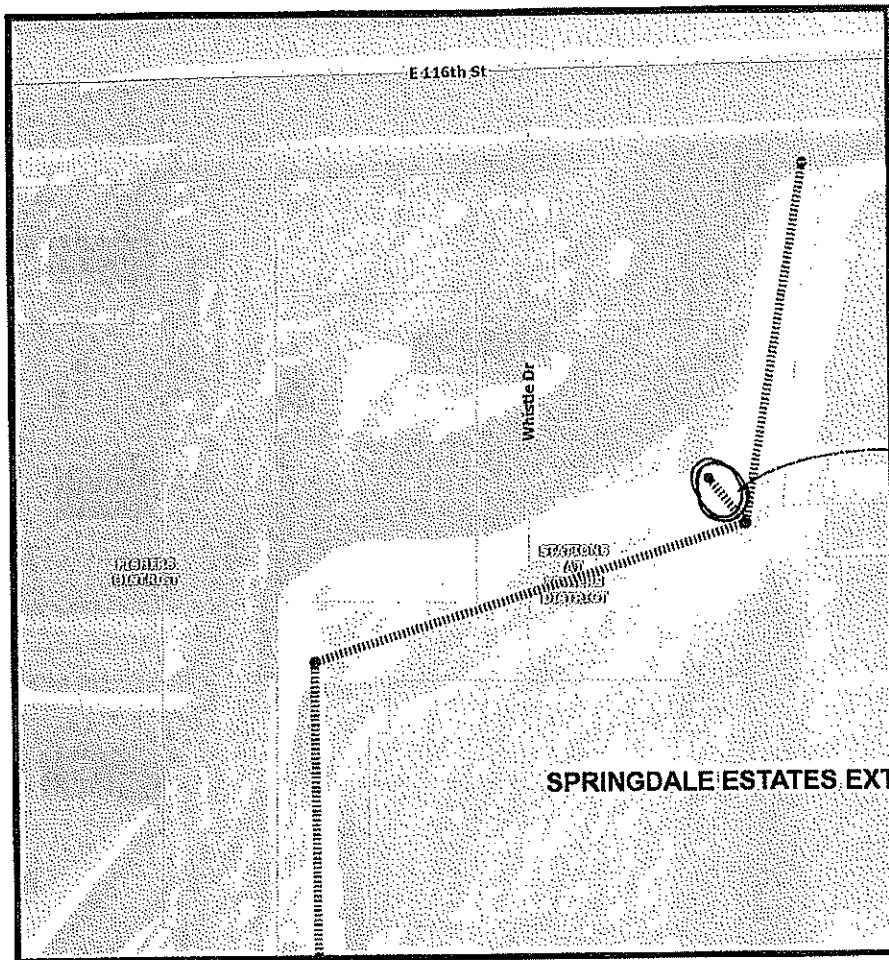

PIPE REMOVED
BY FILSON WITH
INSTALLATION OF
INFRASTRUCTURE.
30' OF 36" RCP

December 2, 2020

1:960

- | | |
|--------------------------|----------------------------|
| Parcel Boundary (public) | MUNICIPAL DRAIN |
| Drainage Structures | OPEN DRAIN |
| All Other Structures | SSD |
| MUNICIPAL MANHOLE | Regulated Drains Waterways |
| Drain Name | Filter Strip |
| Regulated Drains | Grass Waterway |
| CLOSED DRAIN | Swale |

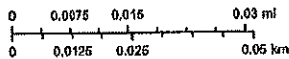

Author: Hamilton County

ough strict accuracy standards have been employed, Hamilton County does not warrant or guarantee the accuracy of the information contained herein and disclaims any and all liability resulting from any error or omission.

Mud Cr - Sand Cr - Springdale Estates Drain Extension - Partial Vacation



December 2, 2020

1:960

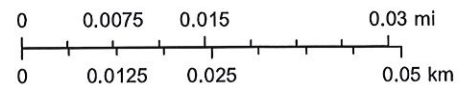

- | | | |
|---|---|--|
| Parcel Boundary (public) | Minor Roads | Drain Name |
| Unincorporated Towns | Lakes & Reservoirs | Regulated Drains |
| Subdivisions | Rivers & Streams | CLOSED DRAIN |
| Interstates & US Highways | Drainage Structures | MUNICIPAL DRAIN |
| State Highways | ● All Other Structures | OPEN DRAIN |
| Major Roads | ⊕ MUNICIPAL MANHOLE | SSD |

Author: Hamilton County

Although strict accuracy standards have been employed, Hamilton County does not warrant or guarantee the accuracy of the information contained herein and disclaims any and all liability resulting from any error or omission.

Mud Creek/Sand Creek, Springdale Estates Extension

Partial Vacation-Addendum to 08/2817 hearing.

*No change in current maintenance assessment.

Hearing: 01/25/21

Parcel	Owner	Description	Benefit	MntAsmt	% of Total
15-15-06-00-13-039.000	116th Stations Fishers IN LLC	S6 T17 R5 The Stations at Fishers District Lot 40	Zero	*	*