

KCW

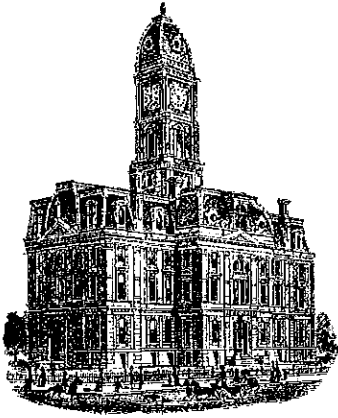

SURVEYOR'S OFFICE  
**Hamilton County**

*Kenton C. Ward, CFM*  
Surveyor of Hamilton County  
Phone (317) 776-8495  
Fax (317) 776-9628

Suite 188  
One Hamilton County Square  
Noblesville, Indiana 46060-2230

June 28, 2012

To: Hamilton County Drainage Board

Re: U.G. Mitchner Drain #275

Upon review of the U.G. Mitchner drainage shed it has been discovered that the park in Delaware Trace should be added to the assessment roll. Parcel 16-10-27-00-00-001.101 owned by the City of Carmel drains to the detention pond directly west of the parcel, which drains south to the Mitchner. This will add \$10.00 to this drains annual assessment.

16-10-27-00-00-001.101, 3.16 Ac, 3.16 Ac benefited; \$10.00 annual assessment.

The fifteen dollar (\$15.00) assessment to the Vestal/Kirkendall should be removed. I recommend the Board set a hearing for August 27, 2012 for this revision.

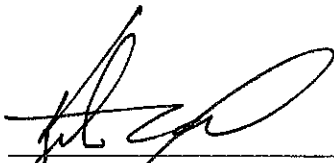
  
\_\_\_\_\_  
Kenton C. Ward, CFM  
Hamilton County Surveyor

KCW/jh

**U.G. Mitchner #275**

Shed Correction

Hearing: 08/27/12

Remove from Vestal & add to Mitchner.

16-10-27-00-001.101	City of Carmel	1 Civic Square	Carmel, IN 46032	S27 T18 R4	3.16Ac	3.16	10.00	100.00
---------------------	----------------	----------------	------------------	------------	--------	------	-------	--------

The \$15.00 assessment to Vestal/Kirkendall #292 will be removed.

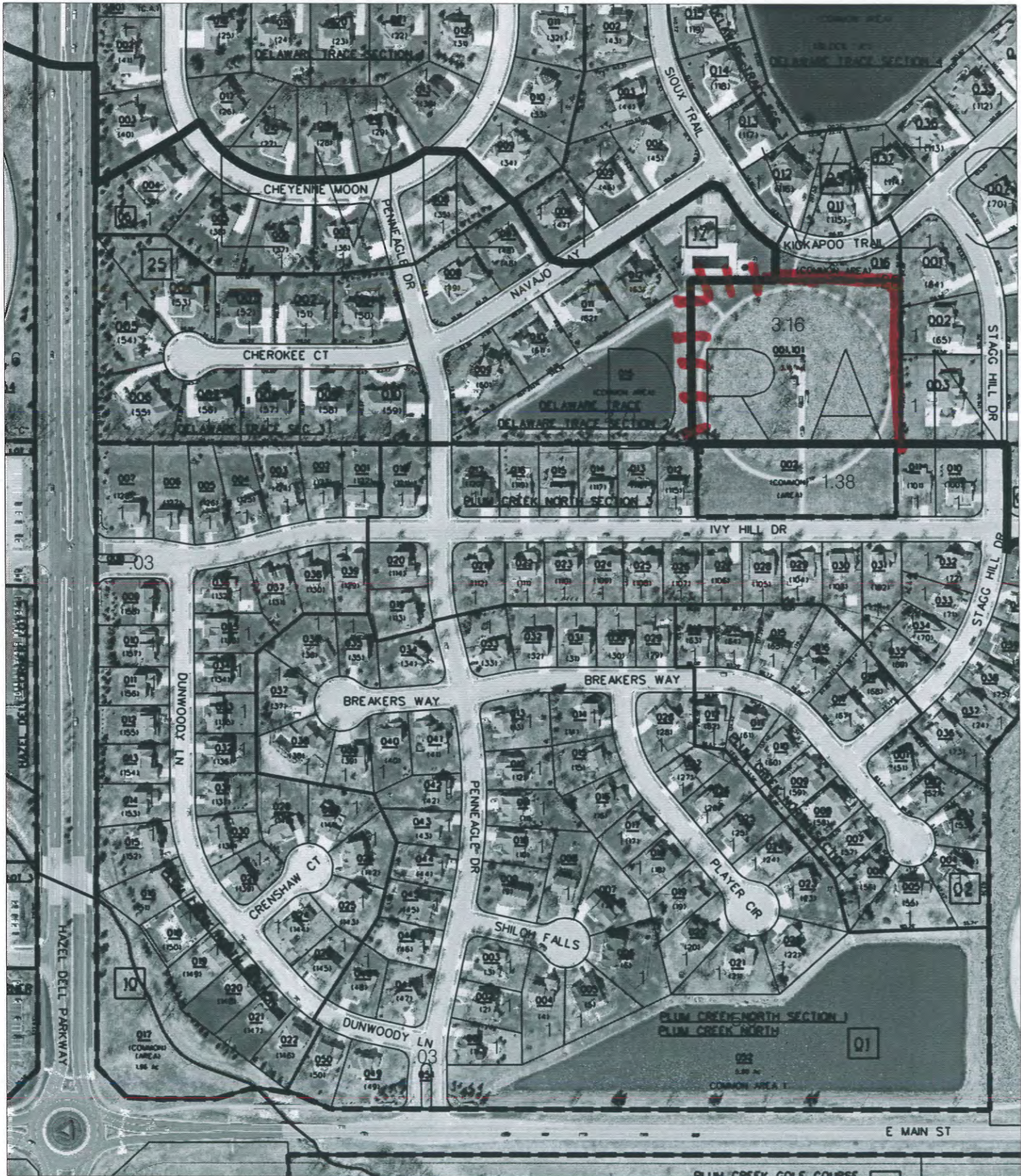

work.rdl 6/26/2012 11:55:29 AM

Parcel 16-10-27-00-00-001.10 Vestal  
 002.000 Mitchner  
 This drainage shed line needs reviewed,